

NOTICE:

Prices and availability are subject to change without notice.

Please contact Marlin Manufacturing before ordering for updated pricing.

CONNECTORS TERMINAL LUGS

Each lug has stamped-in designation of thermocouple type and polarity e.g. JP = Type J positive
JN = Type J negative
(Exception "CU" uncompensated is not designated)

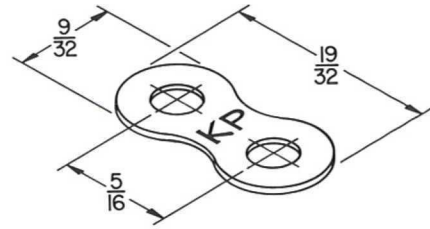
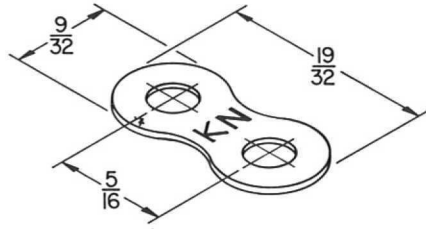

PART NO.	PRICE-SET	HOLE SPACING	FITS CINCH NO.	DISCOUNT SCHEDULE
2140 - (*)	\$1.20	5/16	140	B

(*) Specify type J,K,T,E,R,S,CU,N

Each lug has stamped-in designation of thermocouple type and polarity e.g. JP = Type J positive
JN = Type J negative
(Exception "CU" uncompensated is not designated)

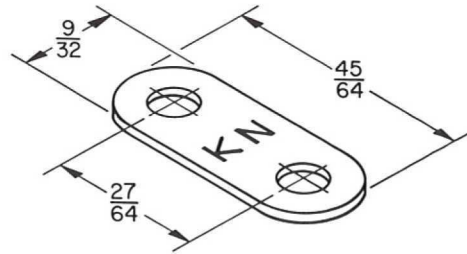
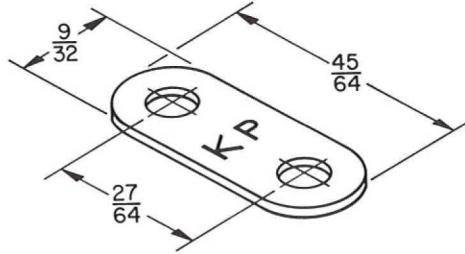

PART NO.	PRICE-SET	HOLE SPACING	FITS CINCH NO.	DISCOUNT SCHEDULE
2141 - (*)	\$1.20	27/64	141	B

(*) Specify type J,K,T,E,R,S,CU,N

TERMINAL LUGS WITH BARRIER STRIP

- 20 Terminals/10 Thermocouple Circuits max per strip
- Molded of bakelite
- Strips are shipped fully assembled with terminal lugs mounted
- 5-40 B.H.D. Screws
- Cinch No. 140
- Hole Spacing 5/16"

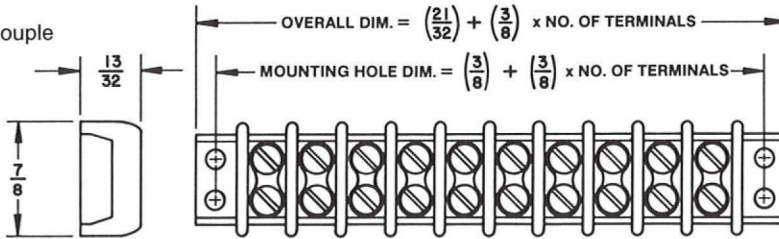

PART NO.	PRICE-CIRCUIT
BS-2140-(*)-()	\$3.00

(*) Specify type J,K,T,E,R,S,CU,N
() Specify number of thermocouple circuits
Discount Schedule "B" applies

- 20 Terminals/10 Thermocouple Circuits max per strip
- Molded of bakelite
- Strips are shipped fully assembled with terminal lugs mounted
- 6-32 B.H.D. Screws
- Cinch No. 141
- Hole Spacing 27/64"

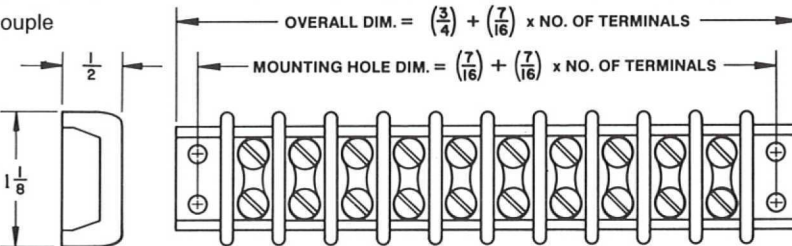

PART NO.	PRICE-CIRCUIT
BS-2141-(*)-()	\$3.00

(*) Specify type J,K,T,E,R,S,CU,N
() Specify number of thermocouple circuits
Discount Schedule "B" applies

TERMINAL SPADE LUGS

Each spade lug has stamped-in designation of thermocouple alloy type.

- e.g. CH = CHROMEL
AL = ALUMEL
IR = IRON
CO = CONSTANTAN
CP = COPPER
II = ALLOY II
NP = NICROSIL
NN = NISIL

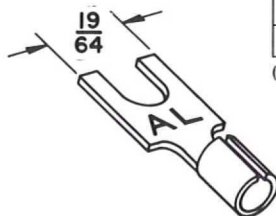

PART NO.	PRICE - EACH	DISC. SCHED.
SL-2141-(*)	\$0.45	B

(*) Specify thermocouple alloy

DISCOUNT SCHEDULE "B"	
QUANTITY**	FACTOR
1-14	NET
15-49	.90
50-99	.85
100-249	.80
250+	.75

**Quantity based on total number of circuits per order of terminal lugs or lugs with barrier strip. Total no. of pieces of terminal spade lugs.

Fits 6-32 (CINCH-141) Terminal Screws. Accepts up to 18 ga. wire for crimp connection.



MANUFACTURING CORPORATION 12404 TRISKETT ROAD CLEVELAND, OHIO 44111

(216) 941-6200
FAX: (216) 941-6207